

# IMPRESSIVE LIGHT CHANNEL STRUCTURE AS A SYMBOL OF CONNECTIVITY

TENNET CAMPUS OFFICE BUILDING, LEHRTE (GERMANY) | NEW BUILDING



© Roland Halbe

Catch everyone's attention: The shape of the impressive light channel structure of the new TenneT campus in Lehrte (Germany) fully reflects the network. The custom-developed lighting solution adds atmosphere to the meeting areas of the office landscape and meets your high creative standards. The unique project was realised with great dedication, commitment and expertise by experienced sales partner *altena GmbH* from Weinstadt (D), in collaboration with *Tulux AG*.

## **Building**

New TenneT campus building, Lehrte (D)

## **Client**

TenneT TSO GmbH, Bayreuth (D)

## **Architect**

KBK Architektengesellschaft Belz | Lutz GmbH, Stuttgart (D)

## **Lighting support**

*altena GmbH*, engineering office for lighting technology, Weinstadt (D)

## **Luminaires**

Tulux AG, Tuggen

Around 650 modern workstations have been created for the cross-border transmission system operator TenneT on the new campus in Lehrte, near Hanover, as a flexible office concept in an open-plan setting. The guiding principle behind the design of the new building was the symbolic grid, which stands for TenneT and for culture and architecture. The ideal grid structure runs through the entire new building – as an indented window front or wall, as a strip of light on the ceilings, as a pattern on the carpet or even in the design of the outdoor areas – everything is perfectly developed and impressive at first glance.



Christian Altena (MEng)  
Managing Director  
Engineering company for lighting technology altena GmbH appreciates Tulux's high standards of implementation.

altena GmbH proved to be the ideal choice for executing the lighting solution. It is renowned for demanding lighting projects and complex lighting solutions and has been able to draw upon its long-standing partnership with Tulux as a leading manufacturer of custom luminaires. 'Implementing the visionary idea of transforming the symbolic grid into a lighting reality while taking all of the technical requirements and standards into account was an ambitious task that could only be achieved by working with an experienced partner,' says Christian Altena. The team has set itself the goal of presenting an excellent solution that meets the exacting technical and design requirements. The result is an imposing, complex structure of light channels, which expresses the idea of connectivity in an impressive way.

'Lighting solutions always consist of 50 % technology, such as standards and glare reduction, and 50 % design, such as a sense of space.'

#### High-contrast lighting creates interest and atmosphere in the room

The network concept is exemplified by the seamless continuation of the light channel structure beyond the boundaries of the space, skilfully creating an optical connection between indoor and outdoor areas. During the implementation of the project, particular attention was paid to the lighting quality and the lighting mood. 'To obtain a high-contrast image, high colour rendering was used throughout. In addition, the correct placement of the individual lighting elements creates brighter and darker zones, creating a sense of excitement and atmosphere in the room,' says Altena. The indirect light effect provides additional dynamism. For this purpose, the covers of the light channels were left protruding approx. 15 mm above the construction instead of sitting flush with the ceiling.

'Good light is as rich in contrast as in nature itself and makes the environment appear alive.'

### Millimetre-precision work for a perfectly fitting ceiling design

One captivating element of the net-like light-channel structure is the ring lights manufactured for the canteen. These artfully surround the skylights and thus optimally complement the incidence of daylight. Each ring light consists of a specially manufactured luminaire channel that has been lasered, bent and welded at Tulux. A major challenge for the design was the uneven ceiling gradient of up to 15.22 %, on which the luminaire channels had to be installed. The accuracy of the fitting at the joints of the individual luminaire elements was particularly crucial. For this reason, each element was individually tailored with millimetre precision and integrated into a previously developed steel construction. The responsible Tulux designer opted for an aluminium U-profile with Y-connectors, which was delivered pre-assembled for the customer. One ingenious extra benefit is that the ring luminaire and all other luminaire elements can be installed without tools thanks to a simple 'click system', which saves valuable time during installation or maintenance.

'From our long-standing partnership, I know that TULUX has not only the competence and expertise, but also the machinery and production facilities necessary to act.'

In addition to the custom luminaire construction in a grid look, the LEAN luminaire makes for an impressive decorative element in the kitchenette, offering perfectly homogeneous all-round lighting. The ZEN LED light band from the Tulux standard collection is used in the meeting rooms and provides the finishing touch to the interior design.

### We design light

We design light, giving it form and an individual radiance: Rather than an arbitrary set of products, SWISS LIGHT CREATIONS stands for precise, convincing Swiss luminaires throughout our range. Our developers create high-quality standard luminaires and custom luminaires according to client requests. We focus on luminaires and lighting systems that are 100% manufactured in Switzerland. Judging from the market's appreciation for what we do, we feel that our claims are justified and that we deliver precisely what we repre-

sent. In Tulux, customers have a competent partner who accompanies and supports them and their vision from idea generation to the finished installation. As Tulux develops and manufactures everything under one roof, the products' functionality is fully guaranteed. The entire Tulux team works to ensure that the project not only shines, but also inspires all who behold it.

## SWISS LIGHT CREATIONS

### IMPRESSIVE LIGHT CHANNEL STRUCTURE AS A SYMBOL OF CONNECTIVITY



The light channel in the 'grid structure' cleverly integrates daylight from the skylight in the canteen.



Reception areas: As an architectural leitmotif, the 'grid' continues across the rooms and visually connects the interior with the exterior.

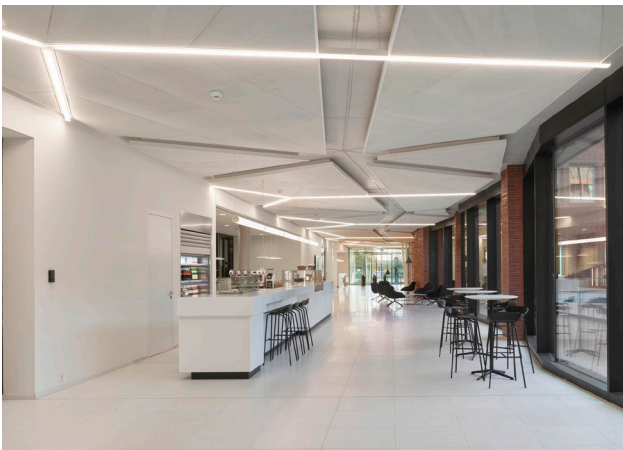

Café: The lighting concept connects spaces.



Kitchenette: The LEAN luminaire provides a creative eye-catching feature and homogeneous, shadow-free illumination.

You can find more references and inspiration at

[www.tulux.ch/produkte/inspirationen](http://www.tulux.ch/produkte/inspirationen)

### Working in partnership

Tulux designs, develops and produces luminaires in Tuggen, Switzerland. In addition to the extensive standard range, it provides custom luminaires based on your specifications.

Tulux is therefore the ideal partner for your projects, no matter how large or small.

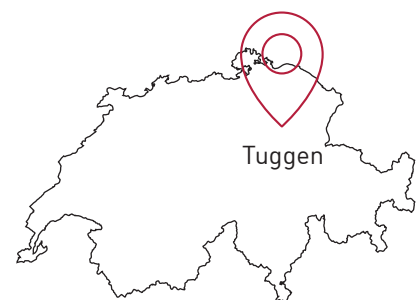
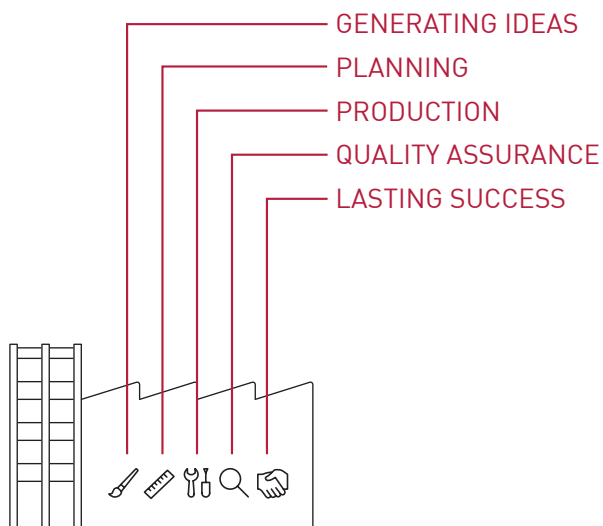

TULUX AG  
8856 TUGGEN, SWITZERLAND  
INFO@TULUX.CH

WWW.TULUX.CH

